

1	Left Front Flare	1
2	Right Front Flare	1
3	Left Rear Flare	1
4	Right Rear Flare	1
5	Edge Trim	289"
6	Adhesive-Backed Mylar Tab	6
7	"S" Clip	6
8	Serrated-Flange Screw	6
9	Red Plastic Tab	1



Step 1: Prior to Installation

- A) **Fit:** Verify that the parts are correct.

FLARE INSTALLATION PROCEDURES

Step 2: Preparing the Work Area

-  A) Using an alcohol/water solution, clean the areas of the vehicle to which the fender flares will be installed.
- B) Inspect the vehicle for damage before installation of fender flares.
- C) Remove factory installed mudflaps, trim pieces, and molding when necessary.

Step 3: Edge Trim Installation (See Illustration #1)

- A) Peel two to three inches of red vinyl backing away from edge trim tape and affix to outer flare edge at one end, leaving a small overhang (approximately 1/4") to be trimmed once edge trim installation is complete. The adhesive strip should be to the inside of the flare.
- (See illustration #1)**
- B) Press edge trim into place along edge of flare in one-foot increments, pulling red vinyl backing free as you continue to work your way around the flare.
-  C) After edge trim is in place, trim ends flush.

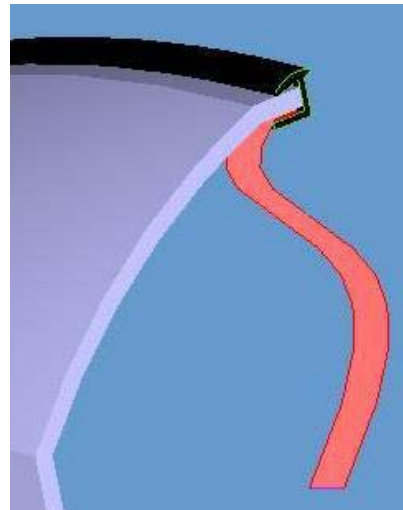

Illustration #1

Step 4: Front Flare Installation (See Images #1 through #7)



Remove and retain two 10mm hex screws at the front of the wheel well. One screw is located on the underside of the front bumper. All hardware removed will be used to attach the front flare later.



Remove and retain two Phillips-head screws at the rear of the wheel well. One screw is located on the underside rear of the fender.

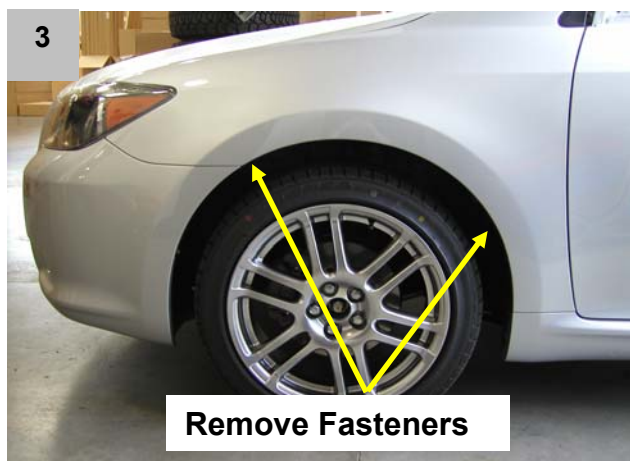

Remove and retain two nylon fasteners in locations as shown.

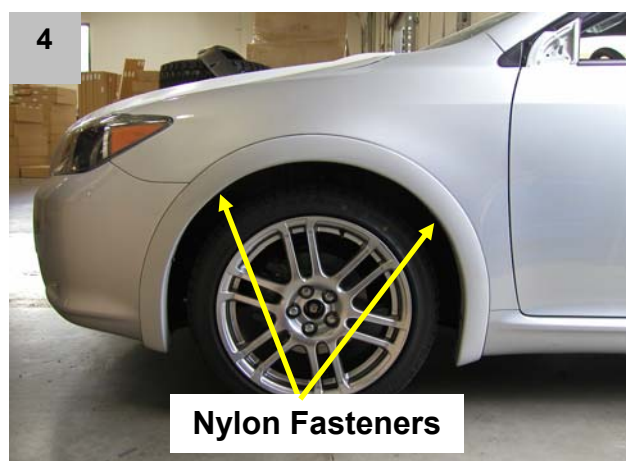

Using moderate pressure, hold the Front Flare in place on the fender, aligning the holes in the flare with the holes in the fender. Reinstall the two nylon fasteners.

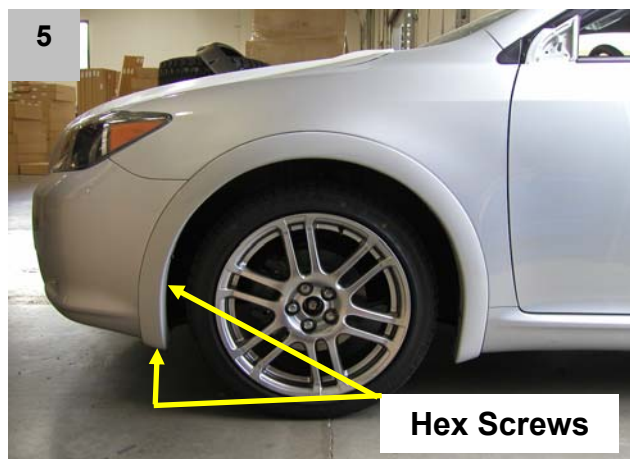

Reinstall the two front 10mm hex-head screws, but do not tighten.



Reinstall the two rear Phillips screws, but do not tighten.



Ensuring that the Front Flare is properly located on the fender, apply moderate pressure to the outside surface of the flare and tighten all screws.

Step 5: Rear Flare Installation (See Images #8 through #19)



Remove and retain one Phillips-head screw at the front of the wheel well. All hardware removed will be used to attach the Rear Flare later.



Remove and retain one 10mm hex-head screw at the rear of the wheel well.



Remove and retain one nylon fastener located on the underside of the rear wheel well.

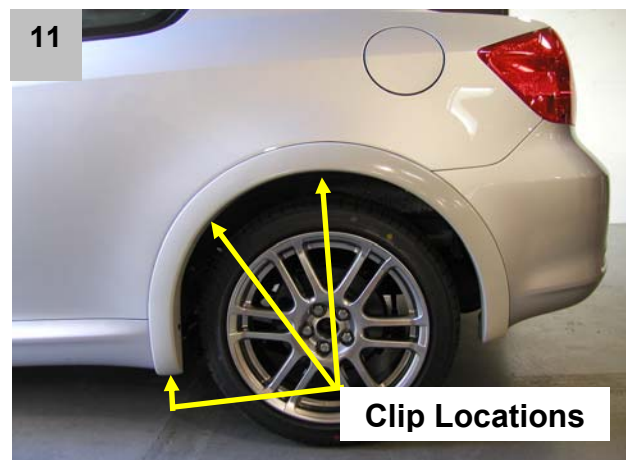

The clips referenced in this image are located at the top of the rear wheel well and on the underside of the rocker panel.



Using the holes at the clip locations in the flare as a guide, mark the hole locations on the fender lip with a grease pencil. (See Step 11 for locations).



Apply a supplied Mylar tab along the edge of the fender, centering the tabs on the marks you made in Step 12. Tabs should be flush to inner edge.



14

Slide "S" Clips over Mylar tabs as shown. Push clips on to the vehicle as far as the clip will allow. Clips should be between the flare and the vehicle.



15

Install a supplied serrated-flange screw through the holes in the Rear Flare and into the threaded holes of the clips, but do not tighten.

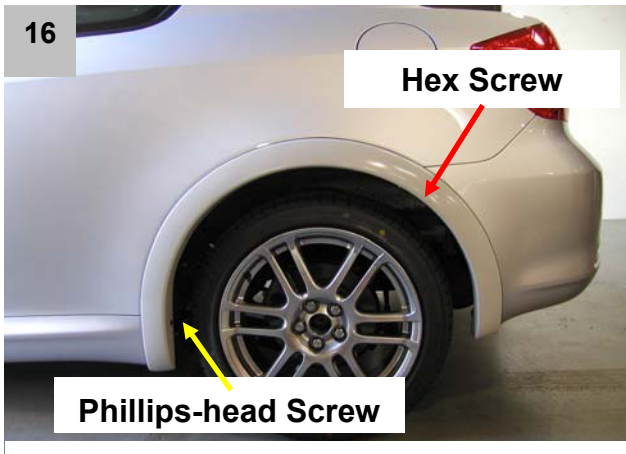

16

Hex Screw

Phillips-head Screw

Using moderate pressure, hold the Rear Flare in place on the fender. Reinstall the Phillips-head screw and the hex-head screw, but do not tighten.

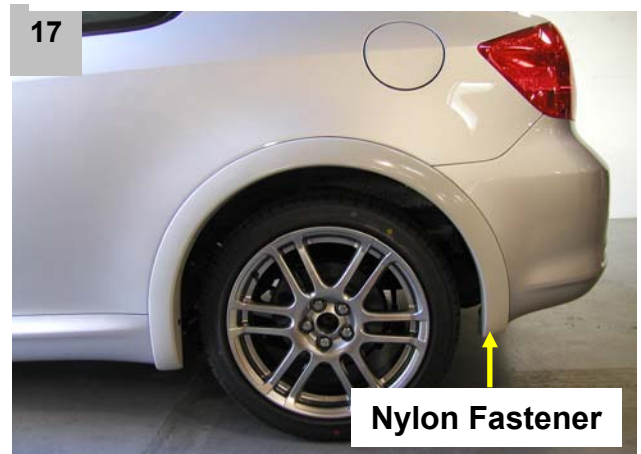

17

Nylon Fastener

Reinstall the nylon fastener.



18

Ensuring that the Rear Flare is properly located on the fender, apply moderate pressure to the outside surface of the flare and tighten all screws.



19



On all four flares, starting at either end of the flare, slip a corner of the red plastic tab between the edge trim and the vehicle body and slide the tab from one end of the flare to the other to seat the edge trim.

NOTE: Use of soap/water solution will help release molding from vehicle fender. The maximum allowable gap between the flare molding and the vehicle is .5mm.